

Customer Information Sheet

DRAWING No.: S447-XX

SHEET 3 OF 3

IF IN DOUBT - ASK

©

NOT TO SCALE

THIRD ANGLE PROJECTION

ALL DIMENSIONS IN mm

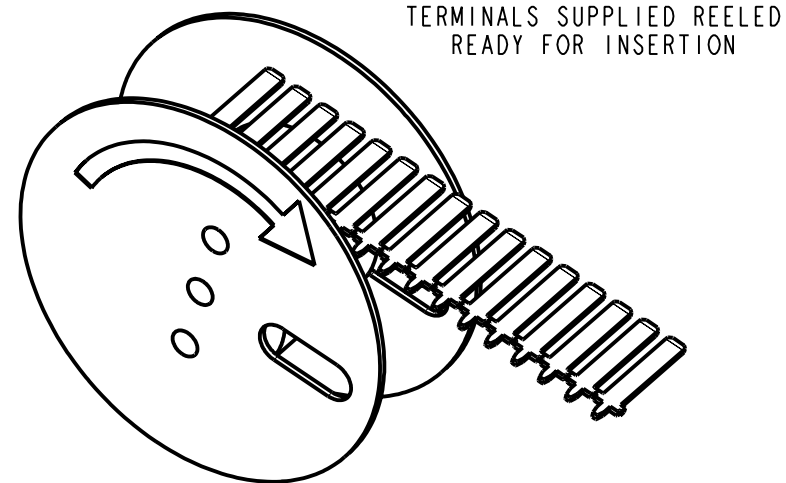
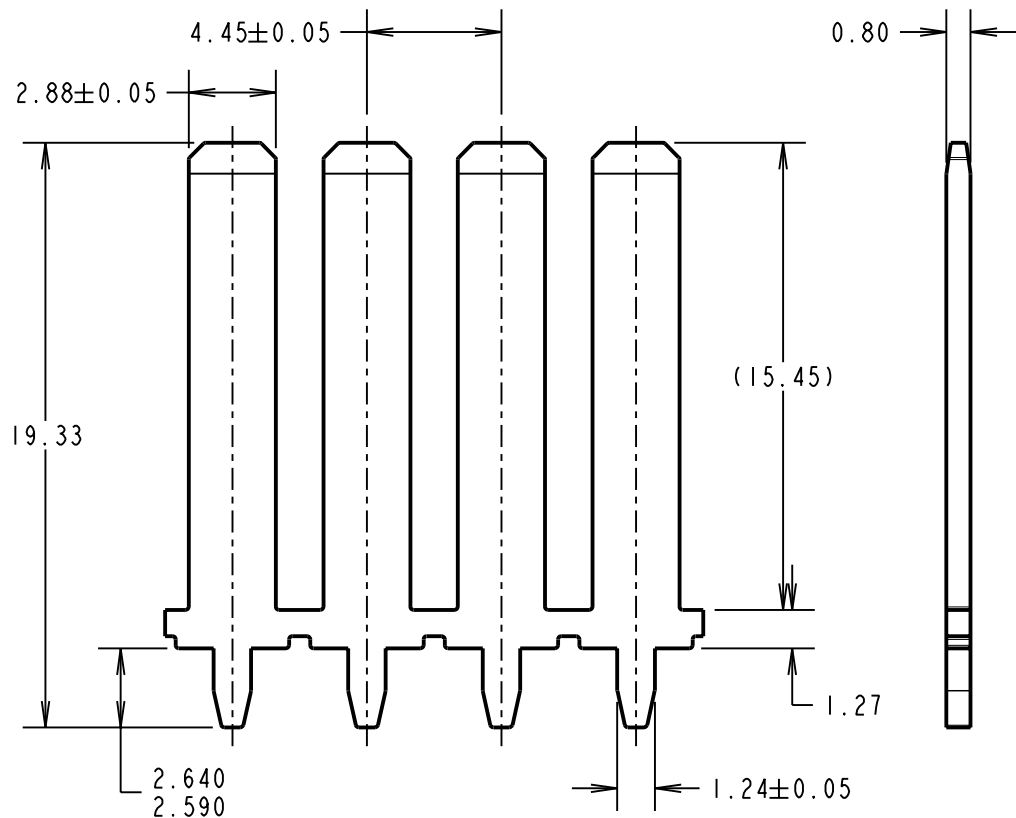

- NOTES:
1. QUANTITY PER REEL = 15,000.
REEL WEIGHT = 5.25kg.
 2. RECOMMENDED PCB THICKNESS = 1.2mm.
 3. RECOMMENDED PCB HOLE SIZE = $\varnothing 1.27 \pm 0.05$ mm.

ORDER CODE:
S447-XX

FINISH _____
~~06 - 4 μ 90/10 TIN/LEAD~~
46 - 4 μ 100% TIN

SB	3	23.03.11	10770
NAME	ISS.	DATE	C/NOTE
APPROVED:		S.BENNETT	
CHECKED:		MARK G PLESTED	
DRAWN:		W. J. BOURNE	
CUSTOMER REF.:			
ASSEMBLY DRG:			

HARWIN

THIS DRAWING AND ANY INFORMATION OR DESCRIPTIVE MATTER SET OUT HEREON ARE CONFIDENTIAL AND COPYRIGHT PROPERTY OF THE HARWIN GROUP AND MUST NOT BE DISCLOSED, LOANED, COPIED OR USED FOR MANUFACTURING, TENDERING OR FOR ANY OTHER PURPOSE WITHOUT THEIR WRITTEN PERMISSION.

TOLERANCES

X. = ± 1 mm
X.X = ± 0.25 mm
X.XX = ± 0.10 mm
X.XXX = ± 0.01 mm

ANGLES = $\pm 5^\circ$

UNLESS STATED

MATERIAL:

BRASS CW505L H095 TO
BS EN 1652
(CuZn30 1/2 HARD)

FINISH: SEE ORDER CODE

S/AREA: mm²

TITLE:

2.88mm BLADE VERTICAL
TERMINAL (REELED)

DRAWING NUMBER:

S447-XX

SHT
3
OF 3

HARWIN USA
TEL: 603 893 5376
FAX: 603 893 5396
mis@harwin.com

HARWIN Europe (UK)
TEL: 023 9231 4545
FAX: 023 9231 4590
mis@harwin.co.uk

HARWIN Asia
TEL: +65 6 779 4909
FAX: +65 6 779 3868
mis@harwin.com.sg