

THIS DRAWING IS UNPUBLISHED.
 © COPYRIGHT BY TYCO ELECTRONICS CORPORATION. ALL RIGHTS RESERVED.

4

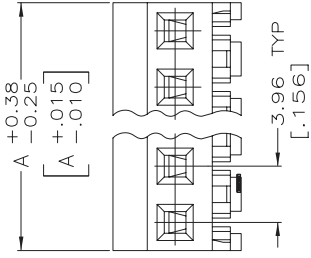
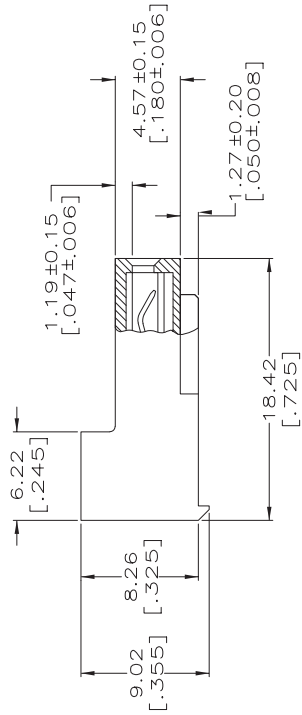
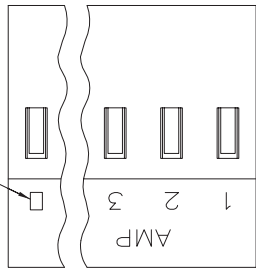

1. MATERIAL: CONNECTOR - NYLON UL94V-2 (WHITE). CONTACTS - 0.30[.012] THICK COPPER ALLOY. PLATING - 0.00038[.000015] GOLD IN CONTACT AREA. 0.00203[.000080] MIN THICKNESS BRIGHT TIN-LEAD IN SLOT AREA FOR 641156-2 THRU 2-641156-4 OR MATTE WHISKER MITIGATED TIN IN SLOT AREA FOR 3-641156-2 THRU 5-641156-4 OVER NICKEL UNDERPLATE.

2. CONTACTS ACCEPT 24 AWG WIRE WITH 2.41[.095] MAX INSULATION DIAMETER.

3. CONTACTS MUST ACCEPT 1.14±0.03[.045±.001] SQUARE POST AND REMAIN LOCKED IN POSITION.

4. IDENTIFICATION NUMBER FOR LAST CIRCUIT MAY NOT APPEAR ON ALL ASSEMBLIES.

5. DIMENSIONS IN BRACKETS ARE IN INCHES.

6. HOUSING FEATURES ARE: CLOSED END WITHOUT LOCKING RAMP.

7. NOTE DELETED.

8. NOTE DELETED.

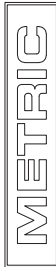

3

LOC CM O
 P LTR H
 ECO-07-012886

REVISIONS
 DESCRIPTION
 DATE

REV 1
 22JUN07
 KW DB

D

C

B

A

NO.	DESCRIPTION	DATE	BY	APP'D
24	5-641156-4	95.10	[3.744]	
23	5-641156-3	91.14	[3.588]	
22	5-641156-2	87.17	[3.432]	
21	5-641156-1	83.21	[3.276]	
20	5-641156-0	79.25	[3.120]	
19	4-641156-9	75.29	[2.964]	
18	4-641156-8	71.32	[2.808]	
17	4-641156-7	67.36	[2.652]	
16	4-641156-6	63.40	[2.496]	
15	4-641156-5	59.44	[2.340]	
14	4-641156-4	55.47	[2.184]	
13	4-641156-3	51.51	[2.028]	
12	4-641156-2	47.55	[1.872]	
11	4-641156-1	43.59	[1.716]	
10	4-641156-0	39.62	[1.560]	
9	3-641156-9	35.66	[1.404]	
8	3-641156-8	31.70	[1.248]	
7	3-641156-7	27.74	[1.092]	
6	3-641156-6	23.77	[.936]	
5	3-641156-5	19.81	[.780]	
4	3-641156-4	15.85	[.624]	
3	3-641156-3	11.89	[.468]	
2	3-641156-2	7.92	[.312]	
24	2-641156-4	95.10	[3.744]	
23	2-641156-3	91.14	[3.588]	
22	2-641156-2	87.17	[3.432]	
21	2-641156-1	83.21	[3.276]	
20	2-641156-0	79.25	[3.120]	
19	1-641156-9	75.29	[2.964]	
18	1-641156-8	71.32	[2.808]	
17	1-641156-7	67.36	[2.652]	
16	1-641156-6	63.40	[2.496]	
15	1-641156-5	59.44	[2.340]	
14	1-641156-4	55.47	[2.184]	
13	1-641156-3	51.51	[2.028]	
12	1-641156-2	47.55	[1.872]	
11	1-641156-1	43.59	[1.716]	
10	1-641156-0	39.62	[1.560]	
9	641156-9	35.66	[1.404]	
8	641156-8	31.70	[1.248]	
7	641156-7	27.74	[1.092]	
6	641156-6	23.77	[.936]	
5	641156-5	19.81	[.780]	
4	641156-4	15.85	[.624]	
3	641156-3	11.89	[.468]	
2	641156-2	7.92	[.312]	

THIS DRAWING IS A CONTROLLED DOCUMENT.

DATE: 3-11-98
 BY: B. LEWIS
 CHK: SWING

PRODUCT SPEC: 108-1051
 APPLICATION SPEC: 114-1020

WEIGHT: -
 FINISH: -

OTHER TOLERANCES UNLESS SPECIFIED:
 0 PLG ±
 1 PLG ±
 2 PLG ±
 3 PLG ±
 4 PLG ±
 ANGLES ±
 FINISH ±

SCALE: 4:1
 SHEET: 1 OF 1
 REV: H

RESTRICTED TO